



TORNADO

15515

Norge / Danmark /
direkt innkopling / direct coupling

1 Fjern pluggen
Remove the plug

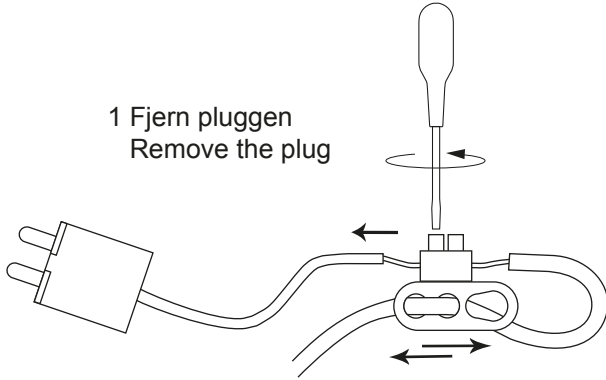

2 Juster lenden på ledningen
Adjust the length of the cord

3 Slå av strømmen
Turn off the power

4. Heng plast øyet på en krok i taket
Suspend the plastic loop on a hook in the ceiling

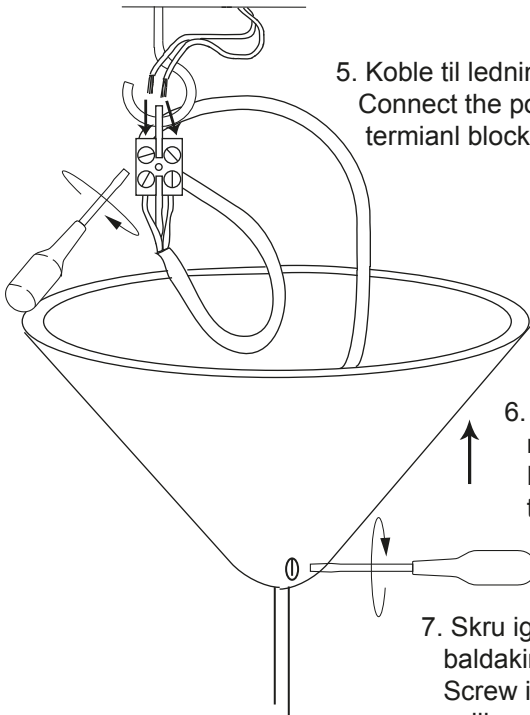

5. Koble til ledningene i sukkerbiten
Connect the power cords to the
terminal block

6. Skyv opp baldakin
mot taket
Push the ceiling cup
to the ceiling

7. Skru igjen skruen på
baldakinen
Screw in the screw in the
ceiling cup

