

Installation of bathroom accessories with 3M tape

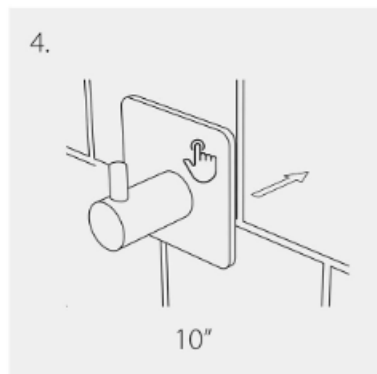
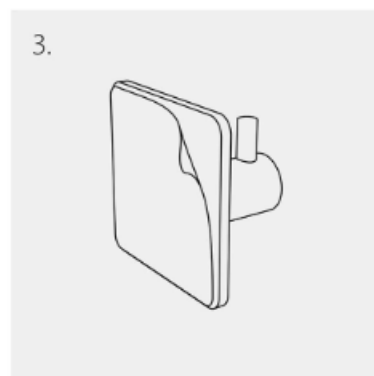
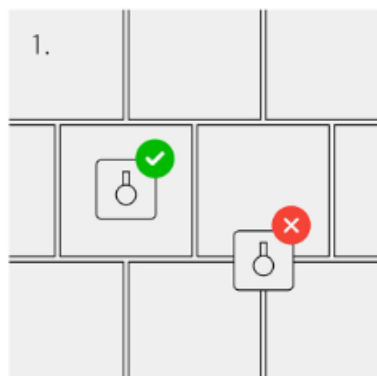

1. Choose a smooth surface for installation and determine the placement of the product. Mark it appropriately to ensure a straight and symmetrical placement.
2. Thoroughly clean the surface to remove any oil and dirt, and let it dry. Use our surface cleaning wipe to effectively remove dirt and grease, ensuring an optimal bonding surface for the 3M products. To remove any lime, grime etc., other detergents suitable for the surface may be needed. Avoid detergents that contain oil. If you are unsure about your specific surface, consult a professional.
3. Remove the protective film by gently peeling it off from the back of the product.
4. Apply the product by pressing it against the surface for 10 seconds.
5. Let the glue harden for 24 hours before subjecting the product to any load for optimal adhesion.
6. The product is ready for use after 24 hours.