

**Einhell**  
**EXPERT**

**GE-CT 18 Li Kit**  
**GE-CT 18 Li**

- D** Originalbetriebsanleitung  
Akku-Rasentrimmer
- GB** Original operating instructions  
Cordless Grass Trimmer
- F** Mode d'emploi d'origine  
Coupe-herbe sans fil
- I** Istruzioni per l'uso originali  
Trimmer a batteria
- S** Original-bruksanvisning  
Batteridrivnen grästrimmer
- NL** Originele handleiding  
Accugazontrimmer
- FIN** Alkuperäiskäyttöohje  
Akkukäyttöinen ruohotrimmari

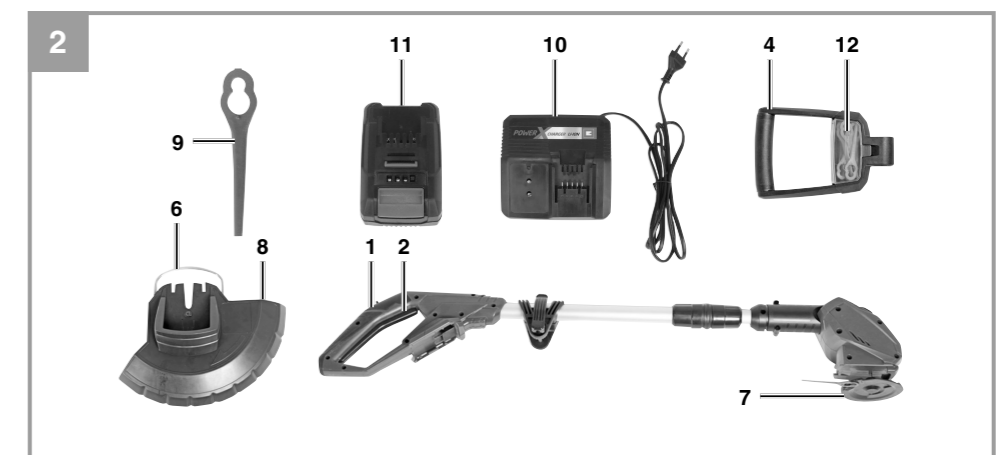
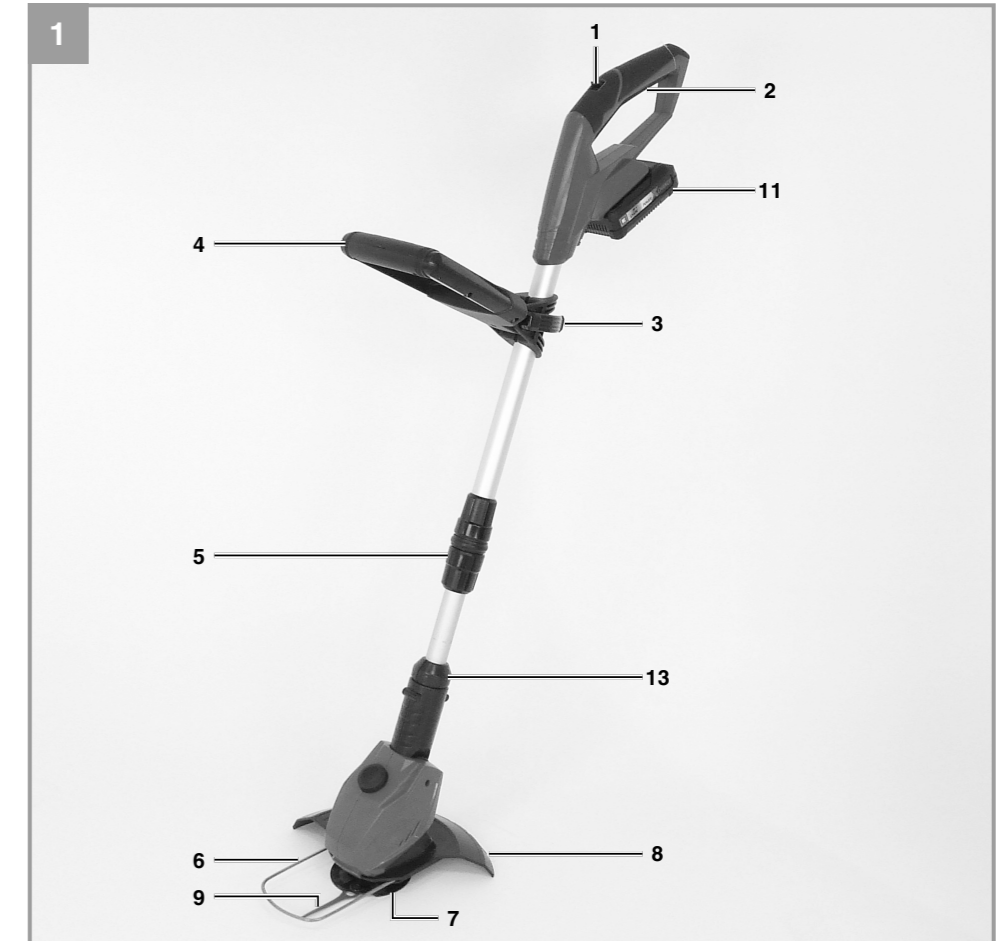

Art.-Nr.: 34.111.70  
Art.-Nr.: 34.111.72

I.-Nr.: 11012  
I.-Nr.: 11012

EH 01/2013 (01)

