



Paulmann

IP 20



Info

www.paulmann.com

Paulmann Licht GmbH  
Quezinger Feld 2  
31832 Springe  
Germany

www.paulmann.com

Art.-Nr.: 709.19



PPN 07/22



2X



4X



2X



4X



4X

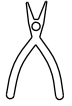

A1 A2 A3

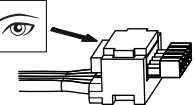
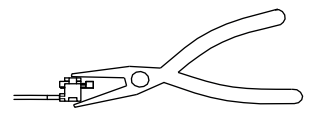
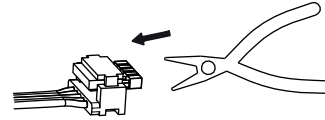
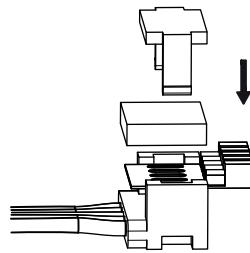
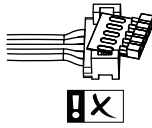
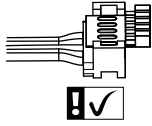
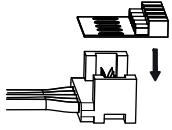

A1 A2 A3

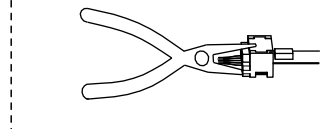
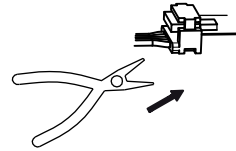
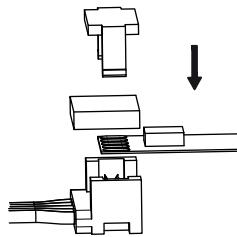
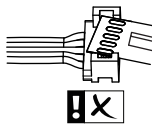
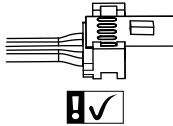
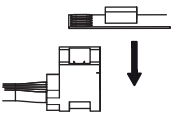

A1 A2 A3

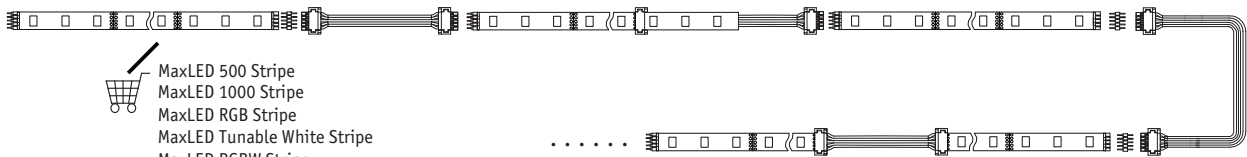
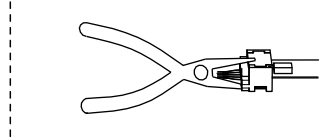
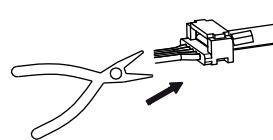
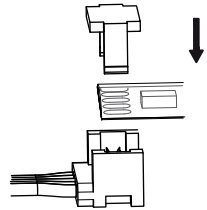
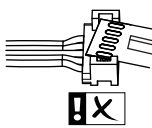
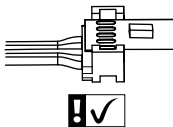

- MaxLED 500 Stripe
- MaxLED 1000 Stripe
- MaxLED RGB Stripe
- MaxLED Tunable White Stripe
- MaxLED RGBW Stripe

MaxLED 500/MaxLED 1000 + MaxLED 500/MaxLED 1000 ✓  
MaxLED RGB + MaxLED RGB ✓

MaxLED RGBW + MaxLED RGBW ✓  
MaxLED Tunable White + MaxLED Tunable White ✓



For MaxLED 1000 stripe

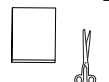
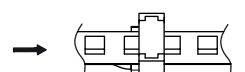
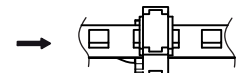
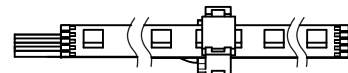
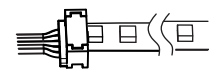
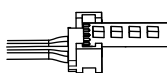

<4mm



= **D** Altgeräte dürfen nicht in den Restmüll. Sie können bei öffentlichen Sammelstellen von Entsorgungsträgern abgegeben werden. Altbatterien und Akkumulatoren, sowie Lampen, die zerstörungsfrei aus dem Altgerät entnommen werden können, sind vor der Abgabe an eine Erfassungsstelle von dem Altgerät zu trennen. Vertreiber sind im Rahmen von § 17 Absatz 1 und 2 ElektroG zur unentgeltlichen Rücknahme dieses Produktes verpflichtet. Endnutzer von Altgeräten müssen eigenverantwortlich für die Löschung personenbezogener Daten auf den zu entsorgenden Altgeräten sorgen.

 [www.paulmann.com](http://www.paulmann.com)