



Safety Instructions



0,1,4,6,7,8,9,11,15,
17,19,20,22,25

Info Hotline

+49 (0) 5041 998 389

Mon. - Do. 7⁰⁰ - 20⁰⁰

Fr. 7⁰⁰ - 17⁰⁰



Paulmann Licht GmbH
31832 Springe / Germany
www.paulmann.com

Art.-Nr.:
926.22
926.26

(+MA 173)

PEV 05/13



926.22

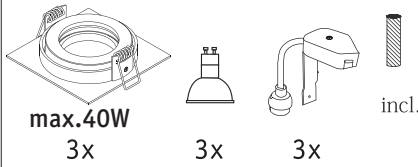

926.26

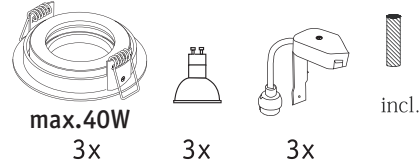

incl.
3x40W
GU10



Paulmann
Art.-Nr.800.36

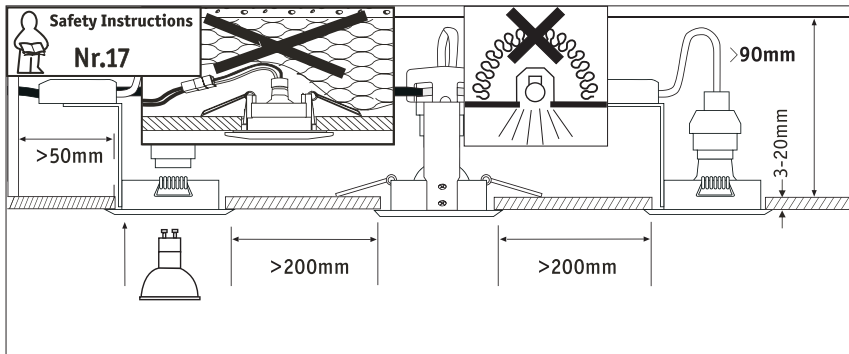
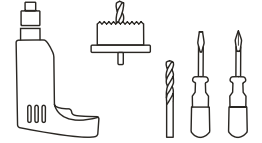

Safety Instructions
Nr. 25

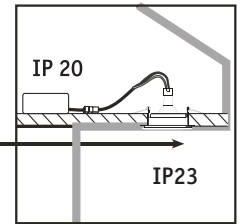
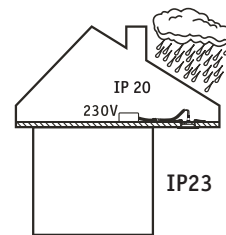

A Safety Instructions
Nr. 0, 1

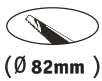

(Ø 82mm)

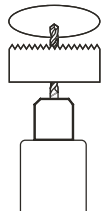

B Safety Instructions
Nr.0,4

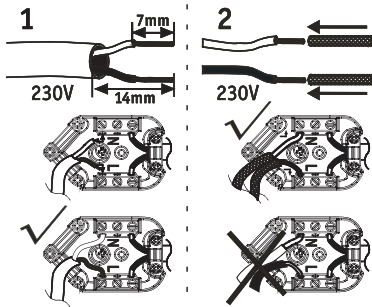
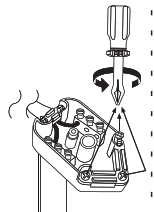

C

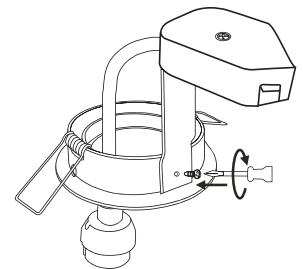

D

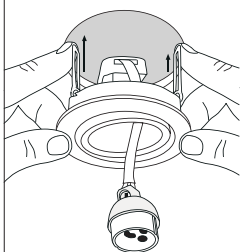

E



F



Safety Instructions
Nr.7,8

G

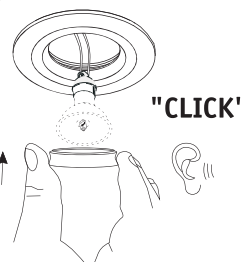

Safety Instructions
Nr.7,8

H

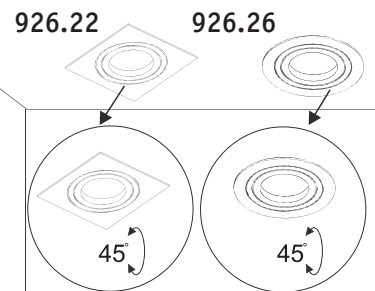

I

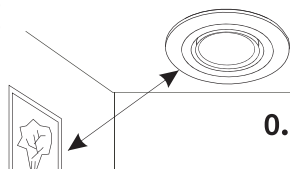

0.5m = 0.5m

Safety Instructions
Nr. 9

max.40W

A, B, C, D, E,
F, G, H, I

