



Safety Instructions



0,1,4,6,7,8,9,11,15,
17,19,20,22,25



Info Hotline  **+49 (0) 5041 998 389**
Mon. - Do. 7⁰⁰ - 20⁰⁰
Fr. 7⁰⁰ - 17⁰⁰

Paulmann Licht GmbH
31832 Springe / Germany
www.paulmann.com

Art.-Nr.:
926.28

(+MA 173)
PEV 05/13 

926.28

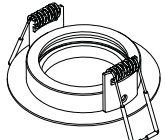

max.40W
1x

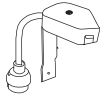

1x



incl.

not incl.
1x40W
GU10



Paulmann
Art.-Nr.800.36

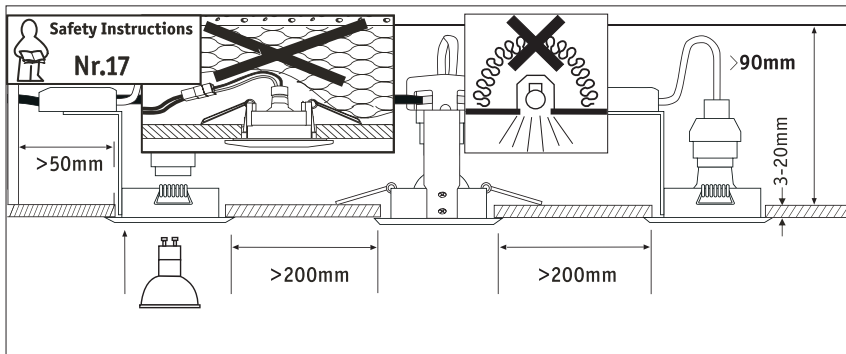
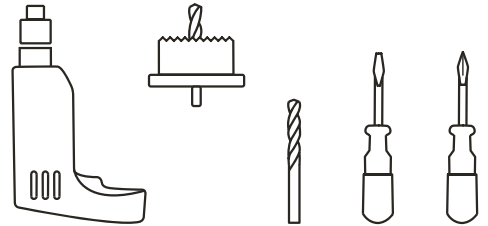

Safety Instructions
Nr. 25

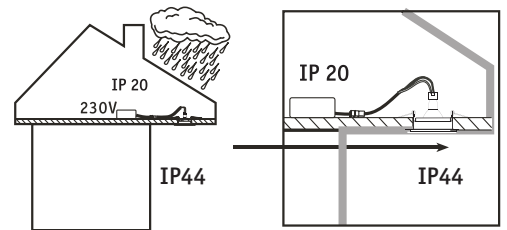

A Safety Instructions
Nr. 0, 1

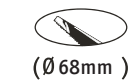

(Ø 68mm)

B Safety Instructions
Nr.0,4

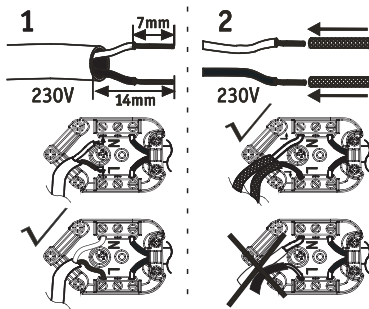
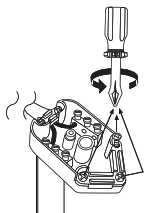
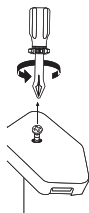

C

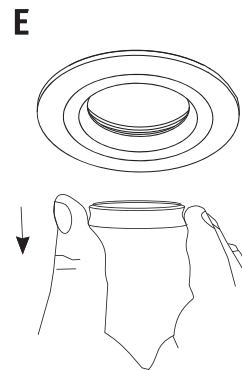
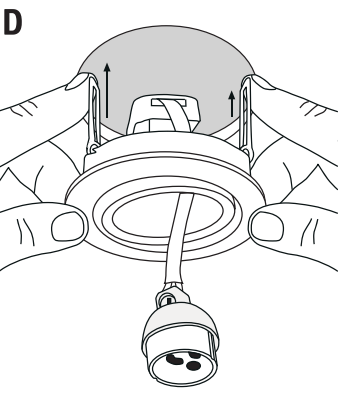
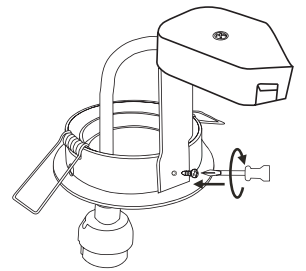

Safety Instructions
Nr.7,8

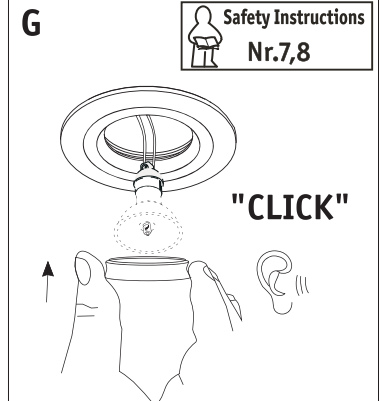

Safety Instructions
Nr.7,8



0.5m =  0.5 m

Safety Instructions
Nr. 9

**A, B, C, D, E,
F, G, H**

max.40W

